

REFRIGERATOR MANUFACTURER
Turbo air
 more durable, efficient, beautiful

4184 E. Conant St.
 Long Beach, CA 90808
 Tel. 310-900-1000
 Fax. 310-900-1077
www.turboairinc.com

Project :	
Model # :	
Item # :	Qty :
Available W/H :	
Approval :	

Glass Door Merchandiser

Glass Door Merchandisers
 Refrigerators

Model : TGM-5R

FEATURES / BENEFITS

EFFICIENT REFRIGERATION SYSTEM

Turbo Air's glass door refrigerators are designed with oversized and balanced (CFC Free R-134A) refrigeration systems. These include efficient evaporators and condensers for faster cooling and greater efficiency.

TASTEFUL AND MODERN APPEARANCE

The design of our products is one of our top priorities. Whether you have a restaurant, bar, convenience store or gas station, Turbo Air refrigerators will compliment the appearance of your operation.

MAGNETIC DOOR GASKETS

Magnetic door gaskets are of one piece construction, removable without tools for ease of cleaning and replacement.

DOUBLE PANE GLASS DOORS WITH HEAT REFLECTING FILM

Equipped with unique double pane glass doors with a layer of patented, transparent thermal insulating film applied between the two glass layers. Lightweight door construction reduces door maintenance and bushing wear, and facilitates smooth door opening.

ADJUSTABLE, HEAVY DUTY, PE (POLYETHYLENE) COATED WIRE SHELVES

The entire cabinet structure and solid doors are foamed-in-place using high density, CFC free polyurethane insulation.

ERGONOMICALLY DESIGNED DOORS

Customers' fatigue fades away with easy grip handles and doors that open effortlessly. These features along with self-closing doors make this the ultimate choice in customer convenience.

BOTTOM MOUNT COMPRESSOR UNITS

Turbo Air's bottom mount compressor allows easier access for service and extra storage space above. In addition, the lower area provides a cooler and less greasy operating environment which results in reduced compressor running time.

REFRIGERATOR HOLDS 33°F ~ 38°F FOR THE BEST IN BEVERAGE PRESERVATION

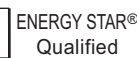

Model	Swing Door	CU./FT.	#of Shelves	HP	AMPS	Crated Weight (lbs.)	L x D* x H (inches)
TGM-5R	1	5	3	1/10	2.2	82	187/8 x 203/4 x 341/8

Model : TGM-5R

ELECTRICAL DATA	
Voltage	115/60/1
Plug Type	ⓘ NEMA-5-15P
Full Load Amperes	2.2
Compressor HP	1/10
Cord Length ft.	9
Refrigerant	R-134A
DIMENSIONAL DATA	
# of Doors	1
Net Capacity cu. ft.	5
Ext. Length Overall in.	18 ⁷ / ₈ (480mm)
Ext. Depth Overall in.*	20 ³ / ₄ (526mm)
Ext. Height Overall in.	34 ¹ / ₈ (867mm)
Int. Length Overall in.	16 ¹ / ₄ (413mm)
Int. Depth Overall in.	17 (432mm)
Int. Height Overall in.	29 ¹ / ₄ (743mm)
Gross Weight lbs.	82
Net Weight lbs.	75
# of Shelves	3
Shelf Size (LxD) in.	16 ¹ / ₈ x 14 ¹ / ₄ , 16 ¹ / ₈ x 15 ³ / ₄ , 16 ¹ / ₈ x 9

Design and specifications subject to change without notice.

Actual shipping weight may differ due to extra packing materials for product protection.

* Depth does not include 1" for door handle and 2" for rear condenser.

- **WARRANTY : 2 Year Parts and Labor Warranty**
Additional 3 Year Warranty on Compressor

- WHITE COLOR CABINET & BLACK COLOR FRAME ON DOOR
- DOUBLE PANE GLASS DOOR WITH THERMAL FILM
- CUSTOMIZED GRAPHICS & COLORS AVAILABLE IN QUANTITY

PLAN VIEW

(unit : inch)

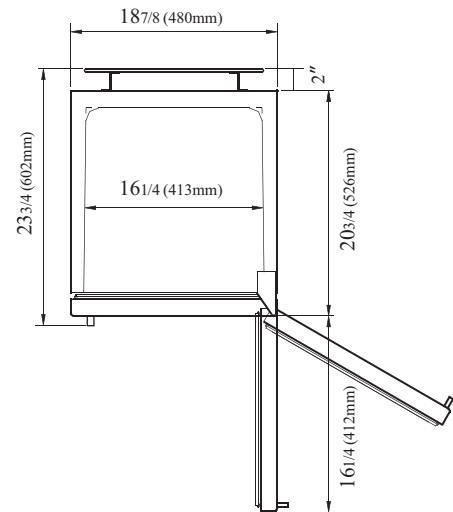

PLAN VIEW

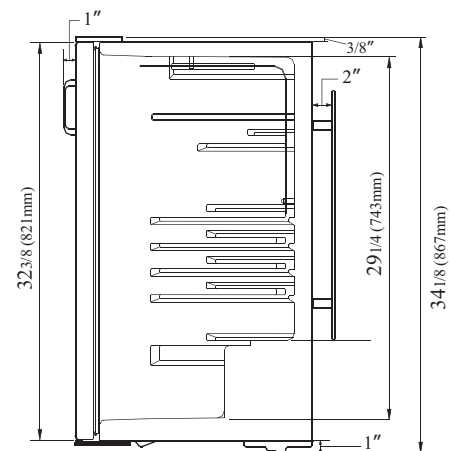

SIDE VIEW

Ver.201401

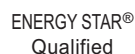

- Turbo Air : 800-627-0032
- GK : 800-500-3519
- Warranty : 800-381-7770
- AC : 888-900-1002