

SOMERSET

DOUGH SHEETER CDR-700

CDR-700 HEAVY DUTY DOUGH SHEETER HIGH PRODUCTIVITY IN A MINIMUM SPACE!

IDEAL FOR:

- HIGH VOLUME PIZZA PRODUCTION
- DOUGH LAMINATION
- DONUT PRODUCTION
- QUALITY PASTRY PRODUCTION
- PASTA

FEATURING:

- Advanced Sheeter exceeding OSHA safety requirements
- Sheets dough up to 40lbs. to a uniform thickness in seconds
- The new All Stainless Steel construction offers Safety, Sanitation, Speed, Simplicity, Durability and Low Cost.



USDA APPROVED AND LISTED

Compact sheeter with front and side operation



The All Stainless Steel heavy duty sheeter Somerset model CDR-700, is an efficient single pass sheeter featuring a 20" wide sliding feed tray allowing the operator to feed up to 40 lbs. of the stiffest dough quickly and easily. The quick-change ratchet handle conveniently allows exact dough thickness.

BAKERY AND FOOD PROCESSING EQUIPMENT AND SYSTEMS SINCE 1946

A-Best Fixture Company

SOMERSET

MODEL CDR-700S, WITH SYNTHETIC ROLLERS

MODEL CDR-700, WITH HARD CHROME PLATED ROLLERS

FEATURES:

- Synthetic or Metallic rollers
- Safety sensors for automatic shutoff
- Compact design, ideal for use in limited space
- Sanitary, heavy duty, all stainless steel welded construction
- Spring loaded scrapers readily removable for easy cleaning
- Simple handle adjustments for exact uniform dough thickness
- Maintenance free drive mechanism, isolated from the roller area
- Removable sliding tray for easy operation, cleaning & space saving
- Heavy duty one horse power drive motor
- Safe...simple...easy to operate...easy to clean
- Ergonomic design, makes it easy and simple to operate

DIMENSIONS

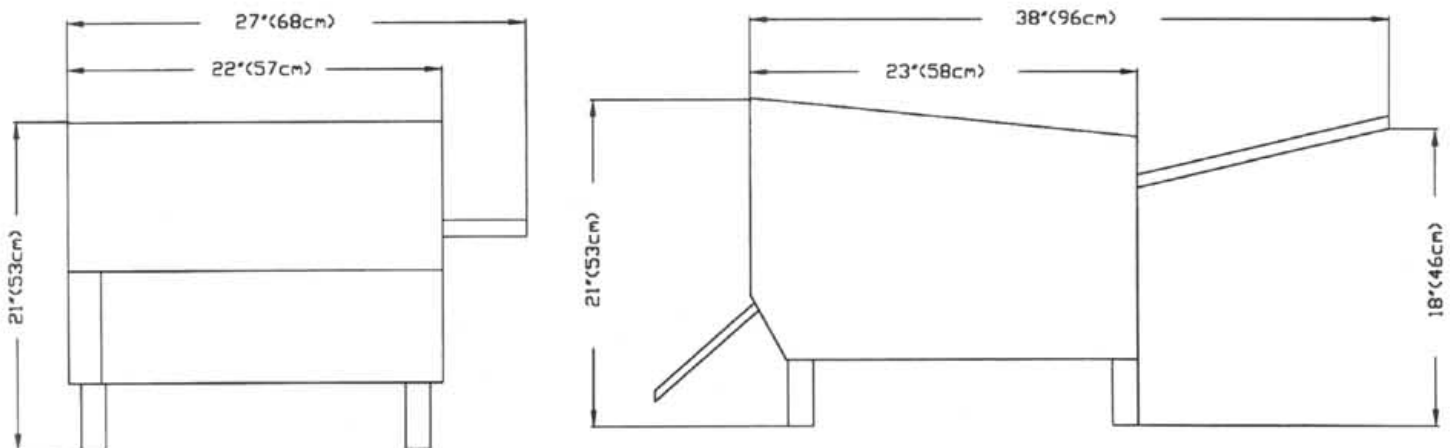

SPECIFICATIONS:

ROLLERS: 3.5" (8.89 cm) Dia. by 20" (50.80 cm) Length
SCRAPERS: Synthetic, Spring Loaded, Removable
BEARINGS: Sealed Ball Bearings, Permanently Lubricated
GEAR MOTOR: Heavy Duty 1 HP Maintenance Free
Single Phase, 115V 60 Hz 12.8 amps
or 220V, 50Hz 6.4 amps

FINISHING: All Stainless Steel.

LEGS: 4" Adjustable, Sanitary Stainless Steel

SHIPPING WEIGHT: 210 lbs.

• SPECIFY SYNTHETIC OR METALIC ROLLERS WHEN ORDERING

CDR7001M1101

SPECIFICATIONS SUBJECT TO CHANGE WITHOUT NOTICE

MADE IN U.S.A.

SOMERSET INDUSTRIES INC. 1 Esquire Road, North Billerica, MA 01862
TEL (978) 667-3355 • 800-772-4404 • FAX (978) 671-9466
e-mail: somerset@smrset.com • Web: <http://www.smrset.com>