

# SOMERSET

## DOUGH SHEETER CDR-700

### CDR-700 HEAVY DUTY DOUGH SHEETER HIGH PRODUCTIVITY IN A MINIMUM SPACE!

#### IDEAL FOR:

- HIGH VOLUME PIZZA PRODUCTION
- DOUGH LAMINATION
- DONUT PRODUCTION
- QUALITY PASTRY PRODUCTION
- PASTA

#### FEATURING:

- Advanced Sheeter exceeding OSHA safety requirements
- Sheets dough up to 40lbs. to a uniform thickness in seconds
- The new All Stainless Steel construction offers Safety, Sanitation, Speed, Simplicity, Durability and Low Cost.



**USDA APPROVED AND LISTED**

**Compact sheeter with front and side operation**



**The All Stainless Steel heavy duty sheeter Somerset model CDR-700, is an efficient single pass sheeter featuring a 20" wide sliding feed tray allowing the operator to feed up to 40 lbs. of the stiffest dough quickly and easily. The quick-change ratchet handle conveniently allows exact dough thickness.**

**BAKERY AND FOOD PROCESSING EQUIPMENT AND SYSTEMS SINCE 1946**

A-Best Fixture Company

# SOMERSET

MODEL CDR-700S, WITH SYNTHETIC ROLLERS

MODEL CDR-700, WITH HARD CHROME PLATED ROLLERS

## FEATURES:

- Synthetic or Metallic rollers
- Safety sensors for automatic shutoff
- Compact design, ideal for use in limited space
- Sanitary, heavy duty, all stainless steel welded construction
- Spring loaded scrapers readily removable for easy cleaning
- Simple handle adjustments for exact uniform dough thickness
- Maintenance free drive mechanism, isolated from the roller area
- Removable sliding tray for easy operation, cleaning & space saving
- Heavy duty one horse power drive motor
- Safe...simple...easy to operate...easy to clean
- Ergonomic design, makes it easy and simple to operate

## DIMENSIONS

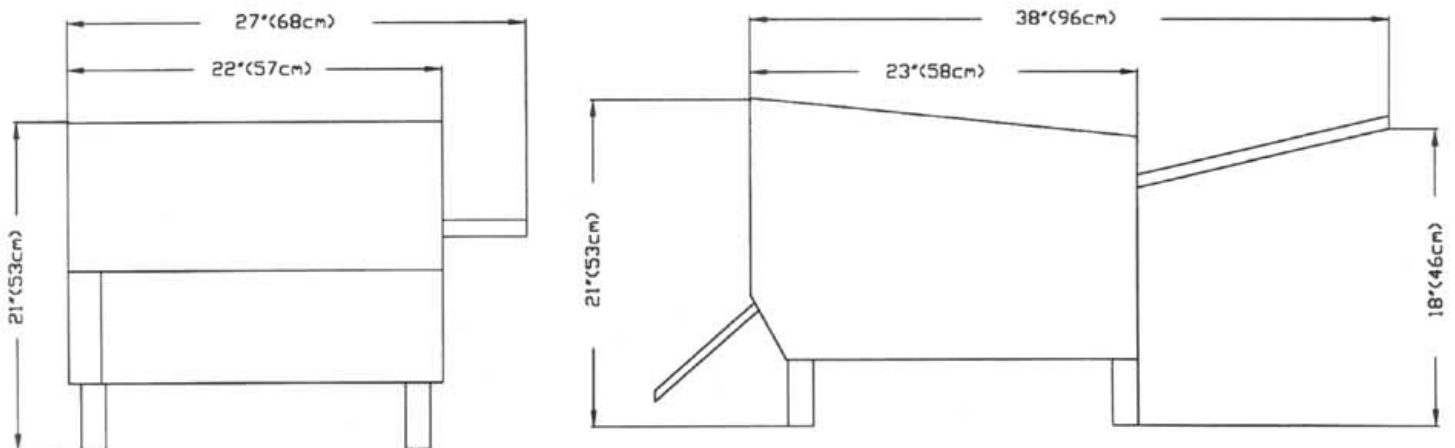

## SPECIFICATIONS:

**ROLLERS:** 3.5" (8.89 cm) Dia. by 20" (50.80 cm) Length  
**SCRAPERS:** Synthetic, Spring Loaded, Removable  
**BEARINGS:** Sealed Ball Bearings, Permanently Lubricated  
**GEAR MOTOR:** Heavy Duty 1 HP Maintenance Free  
Single Phase, 115V 60 Hz 12.8 amps  
or 220V, 50Hz 6.4 amps

**FINISHING:** All Stainless Steel.

**LEGS:** 4" Adjustable, Sanitary Stainless Steel

**SHIPPING WEIGHT:** 210 lbs.

• SPECIFY SYNTHETIC OR METALIC ROLLERS WHEN ORDERING

CDR7001M1101

SPECIFICATIONS SUBJECT TO CHANGE WITHOUT NOTICE

MADE IN U.S.A.

**SOMERSET INDUSTRIES INC. 1 Esquire Road, North Billerica, MA 01862**  
**TEL (978) 667-3355 • 800-772-4404 • FAX (978) 671-9466**  
**e-mail: somerset@smrset.com • Web: <http://www.smrset.com>**