

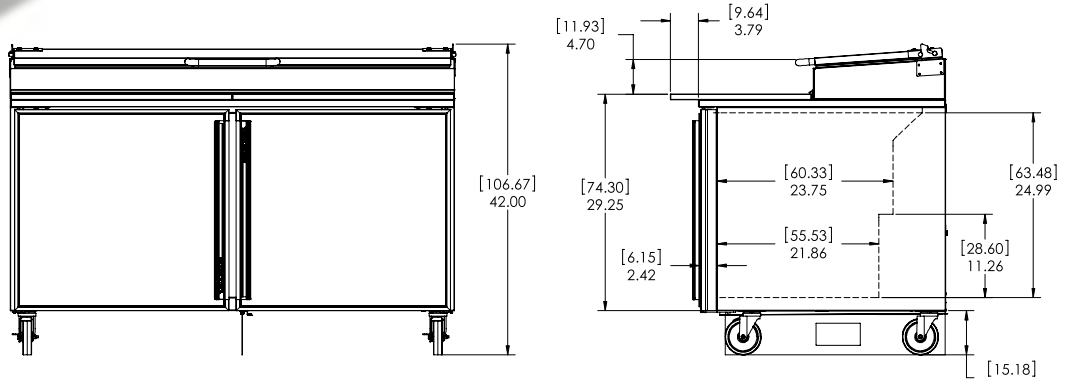

Refrigerated Prep Table

MODEL SKPZ60/C10

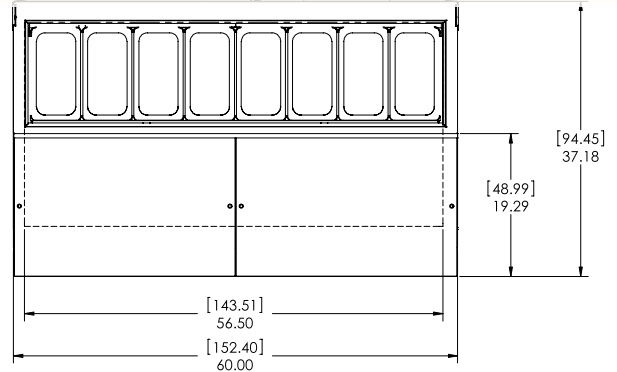

MODEL	LENGTH	DEPTH	HEIGHT	COMPRESSOR	AMPS	WEIGHT
SKPZ60/C10	60"	37.18"	42"	1/3 HP	8.5	470 lbs.

- EXTERIOR** Stainless steel. Galvanized back and bottom.
- INTERIOR** Aluminum. Coved corners and finished edges for ease of cleaning.
- INSULATION** Environmentally friendly foamed-in-place polyurethane for maximum strength and durability.
- DOORS** Heavy-duty magnetic "Thermo Rubber" door gaskets combine to make the toughest, longest lasting door in the industry.
- SHELVES** Heavy gage wire shelves are hand dipped, not sprayed, providing double-thick epoxy coating for superior durability and smooth finish.
- REFRIGERATION** CFC-free, R404a refrigerant, hermetically sealed, high efficiency, self contained refrigeration system. Automatic condensate evaporator means no plumbing or floor drains.
- DOOR GASKETS** Santo Prene material lasts four times industry standard.
- ELECTRICAL** Standard 115 volt, 60 Hz, single phase operation with 8 foot, 3 wire power cord with NEMA 5-15P plug.
- LISTINGS** ETL Safety (U.S. and Canada), ETL Sanitation.



1600 Xenium Lane North
 Minneapolis, MN 55441-3787
 Phone (763) 923-2441
 Fax (763) 553-1209
 www.silverking.com



Specifications subject to change without notice.

1/2015
 © Silver King 2015
 Printed in U.S.A.